

# Fire-resistant doors and screens

**NEW: burglary-resistant RC2 / RC3**

EI30/EI60/EI90/EI120 (T30/F30/T90/F90)

in steel and stainless steel



*ECA, CH-Lausanne, fire-resistant glazings*







Schützenwiese, CH-9451 Kriessern  
Fire-resistant butt-joint glazing EI60



Saxon ministry of finance, DE-Dresden  
Fire doors T30 with arch profile

# NEW: Fire doors with burglar protection RC2 / RC3

If fire protection alone does not meet the security requirements the fireblock fuego light RC2 and RC3 door will provide suitable protection for your building for today's increased demands on safety & security. The slim steel-glass combination offers high quality optics with greater transparency and is extremely durable despite its very narrow appearance. It is suitable for use in residential construction, commercial properties or public buildings with an average burglary risk.

## DESIGN VARIANTS:

- Maximum leaf size up to 3 m (with or without anti panic)
- Anti panic on active and inactive leaf – EN 179/1125
- Pathway / wheelchair accessible, even for anti panic
- Anti panic glazing variant P6B, tested according to SN EN 1627
- Self-locking inactive leaf
- Metal door EI30
- Metal panels EI30
- Screen EI30 / EI60

## Technical details RC2

Material options	Steel ZM and stainless steel 1.4301
Dimensions	Single leaf max. 1400 × 3000 mm (WxH) light clearance Double leaf max. 2830 × 3000 mm (WxH) light clearance
Performance specifications*	EI30 for single and double leaf doors in accordance with EN 1627 EI30 glazing 5.7 m <sup>2</sup> in accordance with EN 1627 EI60 glazing 3.9 m <sup>2</sup> in accordance with EN 1627
System properties	Anti-panic in accordance with EN179/1125 Active and inactive door / glazing P6B Mortise lock with additional locking Prepared profile for mortise locks

## Technical details RC3

Material options	Steel ZM and stainless steel 1.4301
Dimensions	Single leaf max. 1400 × 2500 mm (WxH) light clearance Double leaf max. 2830 × 2500 mm (WxH) light clearance
Performance specifications*	EI30 for single and double leaf doors in accordance with EN 1627 EI30 glazing 5.7 m <sup>2</sup> in accordance with EN 1627 EI60 glazing 3.9 m <sup>2</sup> in accordance with EN 1627
System properties	Anti-panic in accordance with EN179/1125 Active door / Polycarbonate glazing Multipoint safety lock Self-locking Prepared profile for multipoint locks

\*refer to country-specific approvals



Barrier-free accessibility

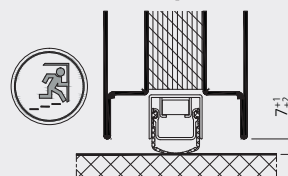

Standard glazing beads

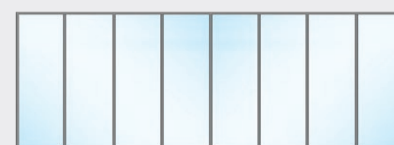
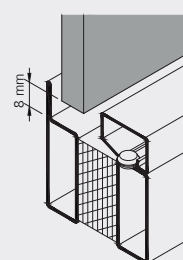



*Banc Raiffeisen, CH-Saxon  
Fire doors and fire protection glazing EI30*



*Hotel Säntispark, CH-Abtwil  
Fire doors and screens EI30*



*Löwenbräu-Areal, CH-Zurich  
Fire doors EI30 made of stainless steel*

948361/10014501/11-16



Udaras Industrial Estate, Ballymakeera, Co. Cork - Tel: 02645560 - Email: info@fireblock.ie